



## Quick-Start Guide



[www.digitalb.net](http://www.digitalb.net)

rev. 2018-10-01 v03

## What's in the box

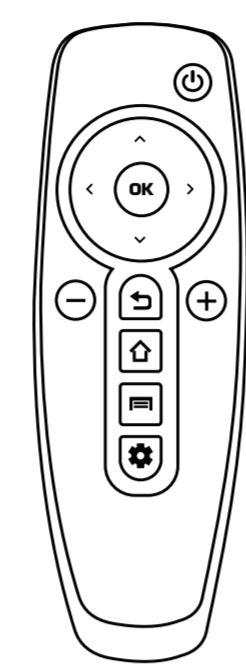

Remote

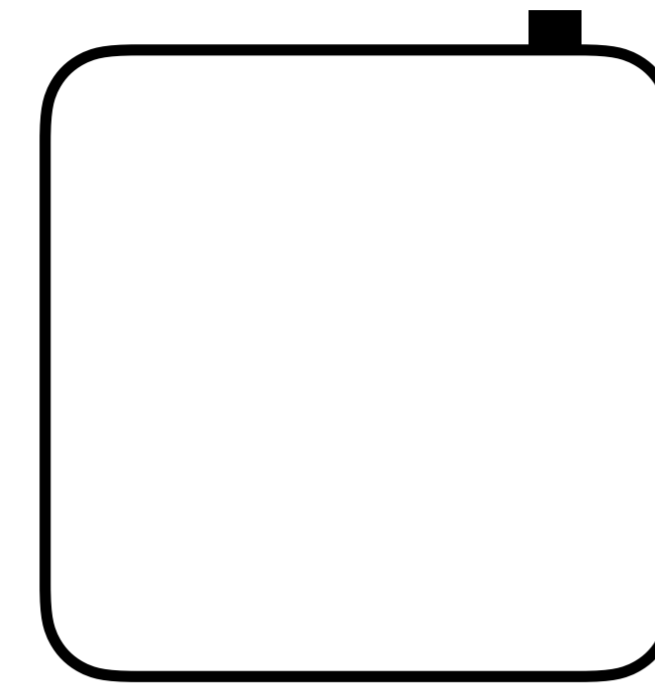

Media Player  
(with included Wall Mount)



Wi-Fi Antenna

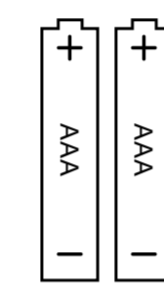

Batteries

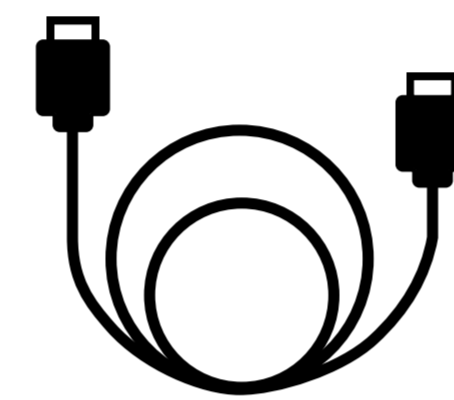

HDMI Cable

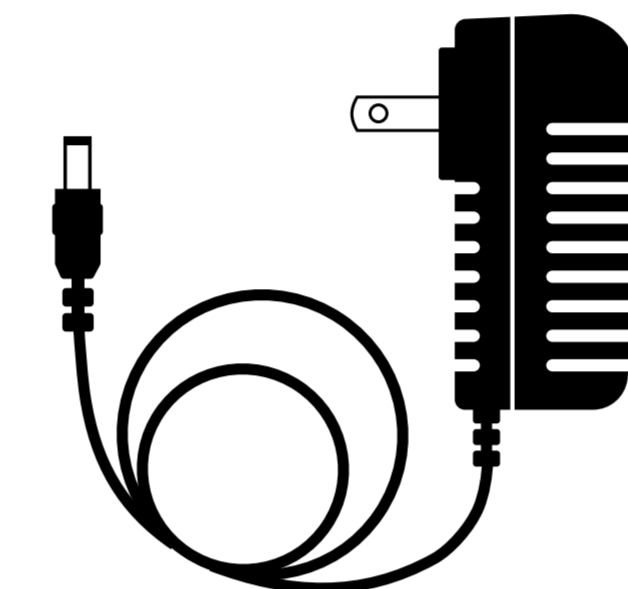

AC Power Adapter

## Tips and troubleshooting

### Wi-Fi

- Use the 5GHz band on your wireless router, if available, for the best Wi-Fi performance.
- If you see a lock icon, the Wi-Fi network requires a password. Make sure you have it available.
- If you need help finding your Wi-Fi password, please refer to your internet service provider for assistance.
- Ensure your internet is working properly. Restarting your router and modem may solve most network issues.
- Do not place your wireless router inside a cabinet, as it may interfere with the Wi-Fi signal.

For more troubleshooting and information about your DigitalB, go to [support.digitalb.net](http://support.digitalb.net)

## 1. Connect your DigitalB

Connect one end of your HDMI cable to your DigitalB and the other end into your TV or monitor. Connect the power adapter to your DigitalB and plug into a nearby outlet or surge protector (recommended). Then select the appropriate HDMI input on your TV or monitor.

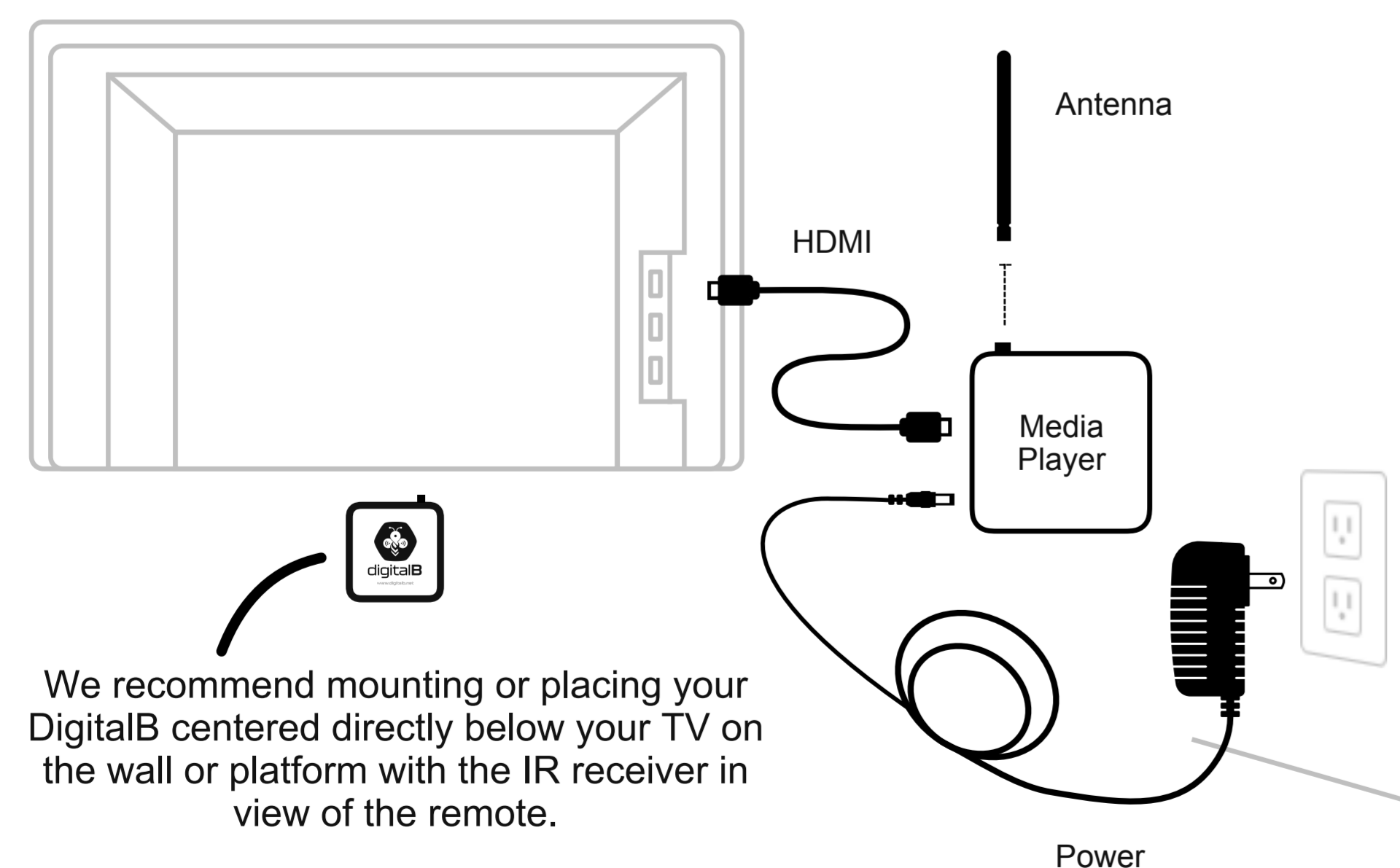

We recommend mounting or placing your DigitalB centered directly below your TV on the wall or platform with the IR receiver in view of the remote.

## 2. Power up your DigitalB Remote

Open the back of the remote and insert the included AAA batteries.

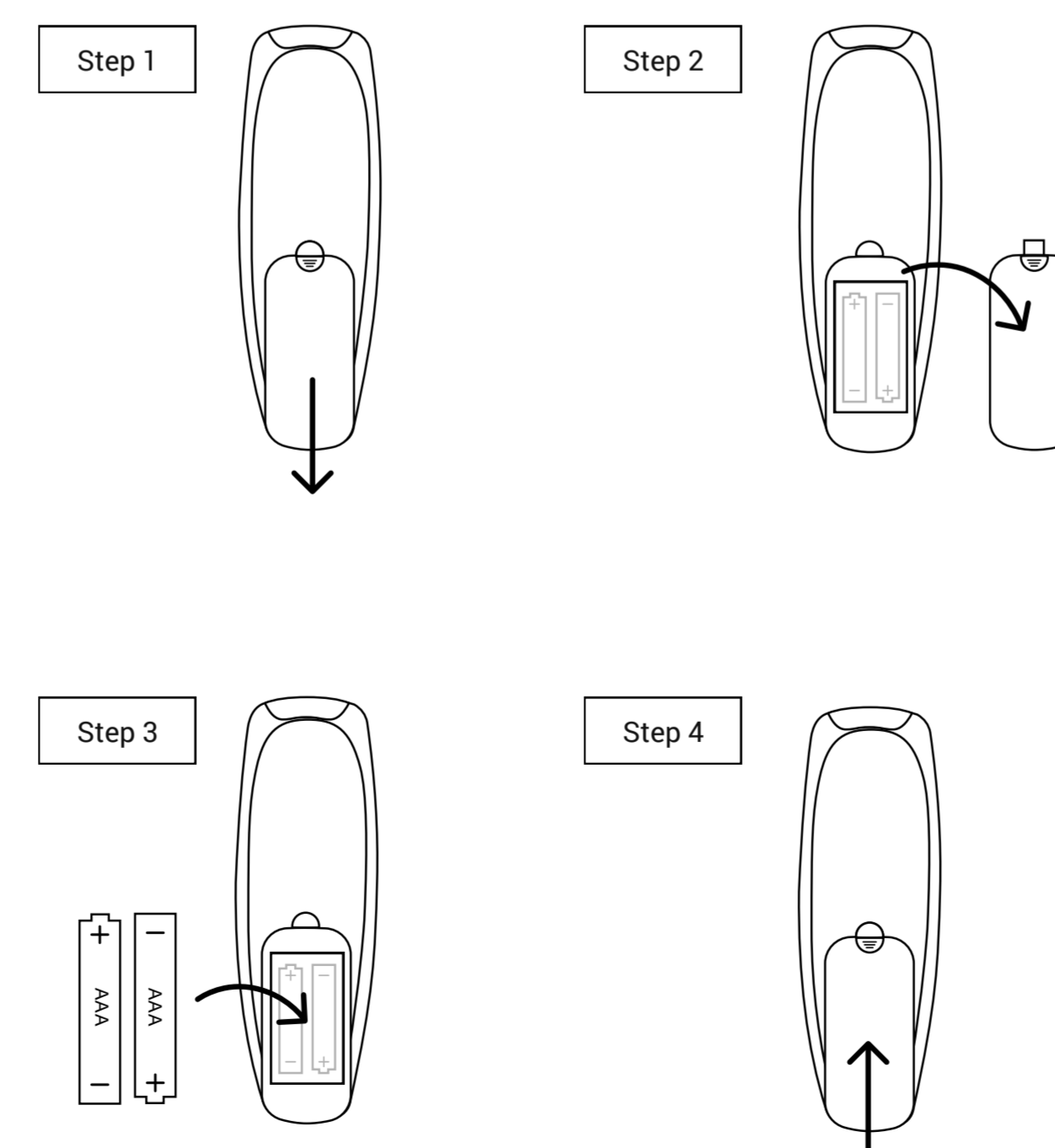

## 3. Complete the on-screen setup

Using the included DigitalB Remote, follow the on-screen instructions to complete the setup.

- Choose your network
- Set the device sleep/wake schedule
- Enter the Activation ID

**Note:** If your Wi-Fi network is password protected, have your Wi-Fi network password handy to connect your DigitalB to the internet. If your network is hidden, select "Join Network" from the list. If required, enter your network password using the on-screen keyboard.

### Register your DigitalB

You should have received an email confirmation including your Activation ID (ex. H-12345678). Please make sure you have your device information available as it will be required for you to complete the setup.