

D I G I T A L  B

Media Player Setup and Activation Instructions

What's Included



DigitalB Media Player



Wireless
Input Device



Power Adapter A



Power Adapter B



HDMI Extension Cable

What You'll Need

- 1080p HD Display or TV
- Tools to Install Wall Bracket

How to Setup Your Device to Your TV

Step 1

Connect the HDMI end of the device into an HDMI port on your TV.

If needed use the HDMI extension cable included in your devices package.

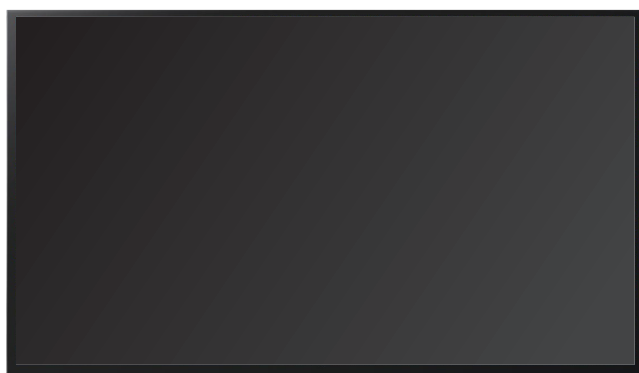

HDMI

Step 2

Connect your A and B power cords. Then, connect one end into your DigitalB and the other into a wall outlet.

Power Cable



Step 3

Connect your wireless USB input device's receiver to your DigitalB.



Step 4

Power on your display and select the proper HDMI port through your display's settings. Then power on your DigitalB Media Player by pressing the power button. Use your wireless input device provided to go through the DigitalB Media Player setup.



If you need to charge your device, plug the mini connector into input device and USB connector into any device with a USB port.

DigitalB Media Player Setup

To setup your DigitalB device follow the illustration steps below.

1. Get Started

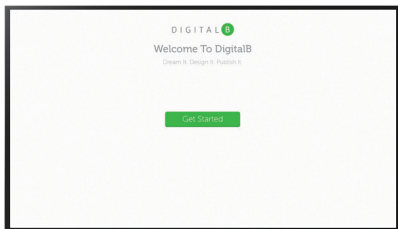

1. Click 

2. Network Setup

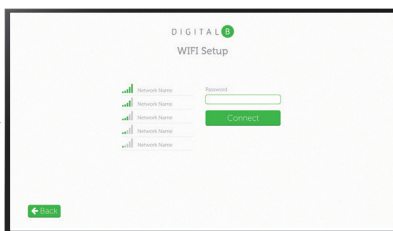
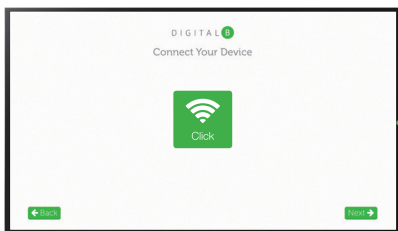

Wifi Setup

Select your Wifi name, enter your password, then click connect.



3. AirPlay® Activation Notice

Once you have connected your device to the Internet, your device will be AirPlay® ready. Click  to continue setup of your DigitalB Media Player.

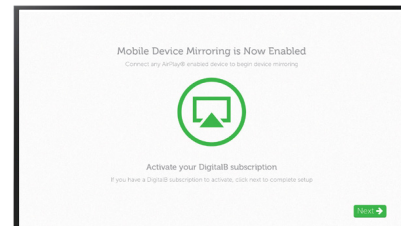

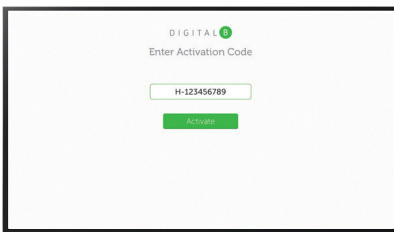

5. Activate Your Device

Enter your activation code found in your DigitalB Account Activation notice email. Once activation code has been entered click to begin displaying your content. 

If you don't have your activation code, please contact DigitalB support at (248) 207 - 5191. It will also be provided for you once you create your online account.

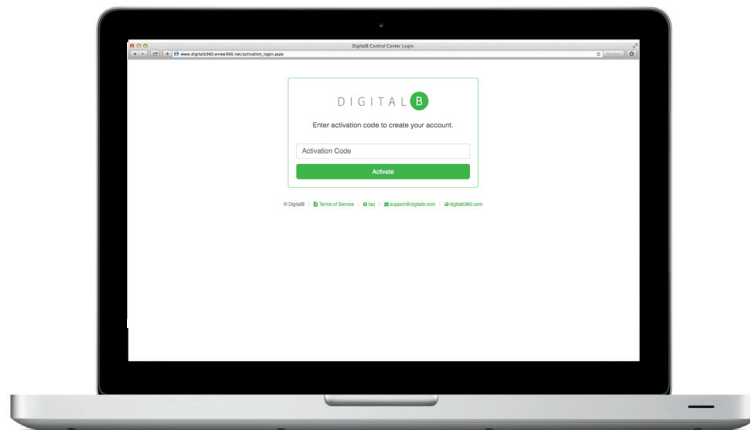

6. Create Your DigitalB User Account

Visit www.digitalb.net/activation_login.aspx. Enter your activation code, click activate, then follow the online instructions.

Notes

- Use your TV or display remote to power off your TV
- Use your TV or display remote to adjust volume
- For further information and FAQ's, please visit support.digitalb.net